

Licensing Act 2003
Premises Licence

PL0610

Part 1 - Premises Details

POSTAL ADDRESS OF PREMISES, OR IF NONE, ORDINANCE SURVEY MAP REFERENCE OR DESCRIPTION

Locomotive Sports Bar

28 Station Street, Burton upon Trent, Staffordshire, DE14 1AU.

Telephone 01283 536631

WHERE THE LICENCE IS TIME LIMITED THE DATES

Not applicable

LICENSABLE ACTIVITIES AUTHORISED BY THE LICENCE

- an exhibition of a film
- a performance of live music
- any playing of recorded music
- a performance of dance
- entertainment of a similar description to that falling within a performance of live music, any playing of recorded music or a performance of dance
- provision of late night refreshment
- the supply of alcohol

THE TIMES THE LICENCE AUTHORISES THE CARRYING OUT OF LICENSABLE ACTIVITIES

Activity (and Area if applicable)	Description	Time From	Time To
B. Exhibition of films (Indoors)			
	Monday to Sunday	10:00am	2:00am
	Christmas Eve	10:00am	3:00am
	Boxing Day	10:00am	3:00am
	New Years Eve	10:00am	3:00am
	Thursdays prior to B/H Weekend	10:00am	2:00am
	Fri Sat Sun & Mon all B Hols	10:00am	2:00am
E. Performance of live music (Indoors)			
	Monday to Sunday	10:00am	2:00am
	Christmas Eve	10:00am	3:00am
	Boxing Day	10:00am	3:00am
	New Years Eve	10:00am	3:00am
	Thursdays prior to B/H Weekend	10:00am	2:00am
	Fri Sat Sun & Mon all B Hols	10:00am	2:00am
F. Playing of recorded music (Indoors)			
	Monday to Sunday	10:00am	2:00am
	Christmas Eve	10:00am	3:00am
	Boxing Day	10:00am	3:00am
	New Years Eve	10:00am	3:00am
	Thursdays prior to B/H Weekend	10:00am	2:00am
	Fri Sat Sun & Mon all B Hols	10:00am	2:00am
G. Performance of dance (Indoors)			
	Monday to Sunday	10:00am	2:00am
	Christmas Eve	10:00am	3:00am
	Boxing Day	10:00am	3:00am



Premises Licence

THE TIMES THE LICENCE AUTHORISES THE CARRYING OUT OF LICENSABLE ACTIVITIES continued ...

Activity (and Area if applicable) Description	Time From	Time To
G. Performance of dance (Indoors) continued ...		
New Years Eve	10:00am	3:00am
Thursdays prior to B/H Weekend	10:00am	2:00am
Fri Sat Sun & Mon all B Hols	10:00am	2:00am
H. Entertainment of a similar description to that falling within E, F, or G (Indoors)		
Monday to Sunday	10:00am	2:00am
Christmas Eve	10:00am	3:00am
Boxing Day	10:00am	3:00am
New Years Eve	10:00am	3:00am
Thursdays prior to B/H Weekend	10:00am	2:00am
Fri Sat Sun & Mon all B Hols	10:00am	2:00am
I. Late night refreshment (Indoors & Outdoors)		
Monday to Sunday	11:00pm	2:30am
Christmas Eve	11:00pm	3:30am
Boxing Day	11:00pm	3:30am
New Years Eve	11:00pm	3:30am
Thursdays prior to B/H Weekend	11:00pm	2:30am
Fri Sat Sun & Mon all B Hols	11:00pm	2:30am
J. Supply of alcohol for consumption ON and OFF the premises		
Monday to Sunday	10:00am	2:00am
Christmas Eve	10:00am	3:00am
Boxing Day	10:00am	3:00am
New Years Eve	10:00am	3:00am
Thursdays prior to B/H Weekend	10:00am	2:00am
Fri Sat Sun & Mon all B Hols	10:00am	2:00am

THE OPENING HOURS OF THE PREMISES

Description	Time From	Time To
Monday to Sunday	10:00am	2:30am
Christmas Eve	10:00am	3:30am
Boxing Day	10:00am	3:30am
New Years Eve	10:00am	3:30am
Thursdays prior to B/H Weekend	10:00am	2:30am
Fri Sat Sun & Mon all B Hols	10:00am	2:30am

WHERE THE LICENCE AUTHORISES SUPPLIES OF ALCOHOL WHETHER THESE ARE ON AND / OR OFF SUPPLIES

- J. Supply of alcohol for consumption ON and OFF the premises

Part 2

NAME, (REGISTERED) ADDRESS, TELEPHONE NUMBER AND EMAIL (WHERE RELEVANT) OF HOLDER OF PREMISES LICENCE

Parmjit Kaur

16 Bank Street, West Bromwich, West Midlands, B71 1HF.
Telephone 07866 078664

p-kaur@hotmail.co.uk



Licensing Act 2003 Premises Licence

PL0610

REGISTERED NUMBER OF HOLDER, FOR EXAMPLE COMPANY NUMBER, CHARITY NUMBER (WHERE APPLICABLE)

NAME, ADDRESS AND TELEPHONE NUMBER OF DESIGNATED PREMISES SUPERVISOR WHERE THE PREMISES LICENCE AUTHORISES THE SUPPLY OF ALCOHOL

Mathew SHAW

25 Oyster Close, Branston, Burton upon Trent, Staffordshire, DE14 3BN.
Telephone 07497 086693

PERSONAL LICENCE NUMBER AND ISSUING AUTHORITY OF PERSONAL LICENCE HELD BY DESIGNATED PREMISES SUPERVISOR WHERE THE PREMISES LICENCE AUTHORISES FOR THE SUPPLY OF ALCOHOL

Licence No. PA1170

Issued by East Staffordshire

ANNEXES

ANNEX 1 - MANDATORY CONDITIONS

This licence is subject to the mandatory conditions set in section 19 Licensing Act 2003 reproduced below :-

Mandatory conditions - supply of alcohol

- (1) No supply of alcohol may be made under the premises licence
 - (a) at a time when there is no designated premises supervisor in respect of the premises licence, or
 - (b) at a time when the designated premises supervisor does not hold a personal licence or his personal licence is suspended.
- (2) Every supply under the premises licence must be made or authorised by a person who holds a personal licence.

The Licensing Act 2003 (Mandatory Conditions) Order 2014

(1) A relevant person shall ensure that no alcohol is sold or supplied for consumption on or off the premises for a price which is less than the permitted price.

(2) For the purposes of the condition set out in paragraph 1-

(a) "duty" is to be construed in accordance with the Alcoholic Liquor Duties Act 1979;

(b) "permitted price" is the price found by applying the formula-

$$P = D + (D \times V)$$

where-

- (i) P is the permitted price,
- (ii) D is the amount of duty chargeable in relation to the alcohol as if the duty were charged on the date of the sale or supply of the alcohol, and
- (iii) V is the rate of value added tax chargeable in relation to the alcohol as if the value added tax were charged on the date of the sale or supply of the alcohol;

(c) "relevant person" means, in relation to premises in respect of which there is in force a premises licence-

- (i) the holder of the premises licence,
- (ii) the designated premises supervisor (if any) in respect of such a licence, or
- (iii) the personal licence holder who makes or authorises a supply of alcohol under such a licence;

(d) "relevant person" means, in relation to premises in respect of which there is in force a club premises certificate, any member or officer of the club present on the premises in a capacity which enables the member or officer to prevent the supply in question; and

(e) "value added tax" means value added tax charged in accordance with the Value Added Tax Act 1994.



ANNEXES continued ...

- (3) Where the permitted price given by Paragraph (b) of paragraph 2 would (apart from this paragraph) not be a whole number of pennies, the price given by that sub-paragraph shall be taken to be the price actually given by that sub-paragraph rounded up to the nearest penny.
- (4) (1) Sub-paragraph (2) applies where the permitted price given by Paragraph (b) of paragraph 2 on a day ("the first day") would be different from the permitted price on the next day ("the second day") as a result of a change to the rate of duty or value added tax.
- (2) The permitted price which would apply on the first day applies to sales or supplies of alcohol which take place before the expiry of the period of 14 days beginning on the second day.

Licensing Act 2003 (Mandatory Conditions)(Amendment) Order 2014

- 1 (1) The responsible person must ensure that staff on relevant premises do not carry out, arrange or participate in any irresponsible promotions in relation to the premises.
- (2) In this paragraph, an irresponsible promotion means any one or more of the following activities, or substantially similar activities, carried on for the purpose of encouraging the sale or supply of alcohol for consumption on the premises-
- (a) games or other activities which require or encourage, or are designed to require or encourage, individuals to-
 - (i) drink a quantity of alcohol within a time limit (other than to drink alcohol sold or supplied on the premises before the cessation of the period in which the responsible person is authorised to sell or supply alcohol), or
 - (ii) drink as much alcohol as possible (whether within a time limit or otherwise);
 - (b) provision of unlimited or unspecified quantities of alcohol free or for a fixed or discounted fee to the public or to a group defined by a particular characteristic in a manner which carries a significant risk of undermining a licensing objective;
 - (c) provision of free or discounted alcohol or any other thing as a prize to encourage or reward the purchase and consumption of alcohol over a period of 24 hours or less in a manner which carries a significant risk of undermining a licensing objective;
 - (d) selling or supplying alcohol in association with promotional posters or flyers on, or in the vicinity of, the premises which can be reasonably be considered to condone, encourage or glamorise anti-social behaviour or to refer to the effects of drunkenness in any favourable manner;
 - (e) dispensing alcohol directly by one person into the mouth of another (other than where that other person is unable to drink without assistance by reason of disability).
- 2 The responsible person must ensure that free potable water is provided on request to customers where it is reasonable available.
- 3 (1) The premises licence holder or club premises certificate holder must ensure that an age verification policy is adopted in respect of the premises in relation to the sale or supply of alcohol.
- (2) The designated premises supervisor in relation to the premises licence must ensure that the supply of alcohol at the premises is carried on in accordance with the age verification policy.
- (3) The policy must require individuals who appear to the responsible person to be under 18 years of age (or such older age as may be specified in the policy) to produce on request, before being served alcohol, identification bearing their photograph, date of birth and either-
- (a) a holographic mark, or
 - (b) an ultraviolet feature.
- 4 The responsible person must ensure that-
- (a) Where any of the following alcoholic drinks is sold or supplied for consumption on the premises (other than alcoholic drinks sold or supplied having been made up in advance ready for sale or supply in a securely closed container) it is available to



ANNEXES continued ...

customers in the following measures-

- (i) Beer or cider: ½ pint;
 - (ii) Gin, rum, vodka or whisky: 25ml or 35ml; and
 - (iii) Still wine in a glass: 125 ml;
- (b) These measures are displayed in a menu, price list or other printed material which is available to customers on the premises; and
- (c) Where a customer does not in relation to a sale of alcohol specify the quantity of alcohol to be sold, the customer is made aware that these measures are available.

Mandatory condition: Door supervision

- 1 Where a premises licence includes a condition that at specified times one or more individuals must be at the premises to carry out a security activity, each such individual must:
- (a) Be authorised to carry out that activity by a licence granted under the Private Security Industry Act 2003; or
 - (b) Be entitled to carry out that activity by virtue of section 4 of the Act.
2. But nothing in subsection 1. Requires such a condition to be imposed:
- (a) in respect of premises within paragraph 8(3)(a) of Schedule 2 to the Private Security Industry Act 2001 (c21)(premises with premises licences authorising plays or films); or
 - (b) in respect of premises in relation to:
 - (i) Any occasion mentioned in paragraph 8(3)(b) or (c) of that Schedule (premises being used exclusively by club with club premises certificate, under a temporary event notice authorising films or under a gaming licence, or
 - (ii) Any occasion within paragraph 8(3)(d) of that Schedule (occasions prescribed by regulations under that Act).
3. For the purpose of this section:
- (a) "security activity" means an activity to which paragraph 2(1)(a) of that Schedule applies, and, which is licensable conduct for the purposes of that Act,
 - (b) paragraph 8(5) of that Schedule (interpretation of references to an occasion) applies as it applies in relation to paragraph 8 of that Schedule.

Mandatory condition: exhibition of films

- (1) Where a premises licence authorises the exhibition of films, the licence must include a condition requiring the admission of children to the exhibition of any film to be restricted in accordance with this section.
- (2) Where the film classification body is specified in the licence, unless subsection (3)(b) applies, admission of children must be restricted in accordance with any recommendation made by that body.
- (3) Where -
 - (a) the film classification body is not specified in the licence, or
 - (b) the relevant licensing authority has notified the holder of the licence that this subsection applies to the film in question,admission of children must be restricted in accordance with any recommendation made by this licensing authority.
- (4) In this section -

"children" means persons aged under 18; and
"film classification body" means the person or persons designated as the authority under section 4 of the Video Recordings Act 1984 (c.39) (authority to determine suitability of video works for classification)



Premises Licence

ANNEXES continued ...

ANNEX 2 - CONDITIONS CONSISTENT WITH THE OPERATING SCHEDULE

The prevention of crime and disorder

- A written record/register must be kept on the premises by the Designated Premises Supervisor of every person employed as a door supervisor in a register kept for that purpose. That record must contain the following details:
The door supervisor's name, date of birth and home address, their individual Security Industry Authority badge number.
Details of the company employing the door supervisors; a contact name, address and telephone number.
This register must be kept fully up to date at all times and must be available for immediate inspection; at the time of the visit, if requested by any responsible authority.
- A duty sheet for every night that door staff are employed will be completed and kept fully updated at all times, this will include a signature from the member of staff at commencement of the duty and at the end of the duty, This duty sheet must be available for immediate inspection upon a request at the time of the visit by any responsible authority.
- A minimum of two Security Industry Authority registered door supervisors must be present when the premises are open for trade on Sunday to Thursday from Midnight and on a Friday and Saturday from 2200hrs and on all occasions must remain at the premises until such time the premises are closed and all members of the public have left the venue.
- A minimum of two door supervisors must also be present when the venue is open on any bank holiday, Sunday prior to a bank holiday, Christmas Eve and New Year's Eve from 2200hrs until the premises are closed and all members of the public have left the venue.
- Furthermore an additional door supervisor must also be present in the outside area when the external bar is open and trading. This will be increased by at least one member of door staff if the side area, defined on the map, is utilised when the external bar is open.
- Door Supervisors must wear yellow high visibility jackets/bibs clearly indicating their role and enabling clear display of their SIA Authority.
- CCTV must be installed and operating correctly to manufacturer's instructions internally and externally and must cover all public areas where licensable activity takes place whilst the premises is open to the public. This must also cover anywhere within the boundaries of the premises where smokers are allowed to congregate.
- The time and date of the CCTV system must be set correctly taking into account BST/GMT.
- A competent trained person in the use of and operation of the CCTV must be in attendance at all times that licensable activities take place and able to fully operate the system and be able to download at the time of the visit to a usb device or disc, provided by the premises, any information requested by any responsible authority.
- All CCTV images must be retained for a periods of not less than 31 days and any evidential incident must be downloaded and secured in a secure system until such time as collected by a responsible authority.
- Clear signage must be displayed at the entrance/s and exit/s that are used by the public indicating that CCTV is in operation.
- On dates stipulated by Staffordshire Police when Burton Albion FC are playing a home game, all drinks are to be served in plastic/polycarbonate receptacles, all bottled products must be decanted and the bottle must be retained by the member of staff. A minimum of two SIA door supervisors must be employed for the duration specified by Staffordshire Police. Furthermore an additional door supervisor must also be present in the outside area when the external bar is open. This will be increased by at least one member of door staff if the side area, defined on the map, is utilised when the external bar is open.
- An incident register of all occurrences and ejections from the premises must be maintained at the premises and any details of any incidents of crime and disorder or misuse of drugs offences must be recorded. The register must be produced and made available at the time of the visit for inspection upon request by any responsible authority.
- All persons involved in the sale of alcohol who are not the holder of a personal licence to sell alcohol must receive initial and regular 6 month refresher training with regards to the law and the sale of alcohol. Such training must be recorded and up to date training records of all such persons shall be maintained at the premises. There must be twelve months records retained. These records must be produced and made available at the time of the visit by any responsible authority.

Public Safety

- No persons will be permitted to take any opened vessels from the boundaries of the premises.



ANNEXES continued ...

The prevention of public nuisance

- A notice advising customers to leave the premises quietly and respect the needs of residents must be displayed at each of the exits that are used by members of the public.
- A notice advising customers to be quiet and respect the needs of residents must be displayed in all outside drinking/smoking areas.

The protection of children from harm

- A Challenge 25 policy must be adopted and enforced at the premises where all persons who appear to be under the age of 25 must be challenged for acceptable identification to prove they are over the age of 18 prior to the purchase of alcohol.
- The only acceptable forms of identification will be a valid photo driving licence, valid passport or valid pass approved proof of age card.
- Challenge 25 posters must be displayed at all entrances of the premises and at the cash till payment areas. These must be displayed prominently and in sight of customers and staff.
- A refusal register with details of all refusals must be maintained at the premises, the register must contain details of the staff member refusing the sale and must be made available for inspection at the time of the visit by any responsible authority.
- There must be no events after 19:00 hours specifically catering for under 18's at the premises except where there has been submitted to the Police Licensing unit a written request with a minimum of 14 days' notice and the Police Licensing Unit have given written consent to the event taking place.
- No persons under the age of 18 to be allowed on the premises after 22:00hrs.

ANNEX 3 - CONDITIONS ATTACHED AFTER A HEARING BY THE LICENSING AUTHORITY

Following a successful Appeal against the decision of East Staffordshire Borough Council's Licensing Authority relating to the Review by Staffordshire Police, the following Condition was ordered on the 4th September 2019:

The Premises shall NOT have the coin operated boxing machine in operation after 2300hrs

ANNEX 4 - PLANS

The plan attached to this licence shows the area at the premises used for each licensable activity.

The plan is marked with reference **08102019/PL0610** held by East Staffordshire Borough Councils - Licensing Section ("The Plan")

The part of the premises shown **edged red** on the attached Plan is authorised for:

Supply of alcohol (On and Off the premises)
Provision of late night refreshment (Indoors and Outdoors)
Performance of live music (Indoors)
Recorded Music (Indoors)
Performance of dance (Indoors)
Exhibition of films (Indoors)
Entertainment of a similar description to that falling within E, F or G (Indoors)

The part of the premises shown **edged blue** on the attached Plan is authorised for:

Late night refreshment



Licensing Act 2003

Premises Licence

PL0610

HEAD OF SERVICE
Issued under delegated powers

Date original licence issued:



Premises Licence Summary

Premises Details

POSTAL ADDRESS OF PREMISES, OR IF NONE, ORDANCE SURVEY MAP REFERENCE OR DESCRIPTION

Locomotive Sports Bar

28 Station Street, Burton upon Trent, Staffordshire, DE14 1AU.

Telephone 01283 536631

WHERE THE LICENCE IS TIME LIMITED THE DATES

Not applicable

LICENSABLE ACTIVITIES AUTHORISED BY THE LICENCE

- an exhibition of a film
- a performance of live music
- any playing of recorded music
- a performance of dance
- entertainment of a similar description to that falling within a performance of live music, any playing of recorded music or a performance of dance
- provision of late night refreshment
- the supply of alcohol

THE TIMES THE LICENCE AUTHORISES THE CARRYING OUT OF LICENSABLE ACTIVITIES

Activity (and Area if applicable)	Description	Time From	Time To
B. Exhibition of films (Indoors)	Monday to Sunday	10:00am	2:00am
	Christmas Eve	10:00am	3:00am
	Boxing Day	10:00am	3:00am
	New Years Eve	10:00am	3:00am
	Thursdays prior to B/H Weekend	10:00am	2:00am
	Fri Sat Sun & Mon all B Hols	10:00am	2:00am
	E. Performance of live music (Indoors)	Monday to Sunday	10:00am
Christmas Eve		10:00am	3:00am
Boxing Day		10:00am	3:00am
New Years Eve		10:00am	3:00am
Thursdays prior to B/H Weekend		10:00am	2:00am
Fri Sat Sun & Mon all B Hols		10:00am	2:00am
F. Playing of recorded music (Indoors)		Monday to Sunday	10:00am
	Christmas Eve	10:00am	3:00am
	Boxing Day	10:00am	3:00am
	New Years Eve	10:00am	3:00am
	Thursdays prior to B/H Weekend	10:00am	2:00am
	Fri Sat Sun & Mon all B Hols	10:00am	2:00am
	G. Performance of dance (Indoors)	Monday to Sunday	10:00am
Christmas Eve		10:00am	3:00am
Boxing Day		10:00am	3:00am



Premises Licence Summary

THE TIMES THE LICENCE AUTHORISES THE CARRYING OUT OF LICENSABLE ACTIVITIES continued ...

Activity (and Area if applicable)	Description	Time From	Time To
G. Performance of dance (Indoors) continued ...			
	New Years Eve	10:00am	3:00am
	Thursdays prior to B/H Weekend	10:00am	2:00am
	Fri Sat Sun & Mon all B Hols	10:00am	2:00am
H. Entertainment of a similar description to that falling within E, F, or G (Indoors)			
	Monday to Sunday	10:00am	2:00am
	Christmas Eve	10:00am	3:00am
	Boxing Day	10:00am	3:00am
	New Years Eve	10:00am	3:00am
	Thursdays prior to B/H Weekend	10:00am	2:00am
	Fri Sat Sun & Mon all B Hols	10:00am	2:00am
I. Late night refreshment (Indoors & Outdoors)			
	Monday to Sunday	11:00pm	2:30am
	Christmas Eve	11:00pm	3:30am
	Boxing Day	11:00pm	3:30am
	New Years Eve	11:00pm	3:30am
	Thursdays prior to B/H Weekend	11:00pm	2:30am
	Fri Sat Sun & Mon all B Hols	11:00pm	2:30am
J. Supply of alcohol for consumption ON and OFF the premises			
	Monday to Sunday	10:00am	2:00am
	Christmas Eve	10:00am	3:00am
	Boxing Day	10:00am	3:00am
	New Years Eve	10:00am	3:00am
	Thursdays prior to B/H Weekend	10:00am	2:00am
	Fri Sat Sun & Mon all B Hols	10:00am	2:00am

THE OPENING HOURS OF THE PREMISES

Description	Time From	Time To
Monday to Sunday	10:00am	2:30am
Christmas Eve	10:00am	3:30am
Boxing Day	10:00am	3:30am
New Years Eve	10:00am	3:30am
Thursdays prior to B/H Weekend	10:00am	2:30am
Fri Sat Sun & Mon all B Hols	10:00am	2:30am

WHERE THE LICENCE AUTHORISES SUPPLIES OF ALCOHOL WHETHER THESE ARE ON AND / OR OFF SUPPLIES

- J. Supply of alcohol for consumption ON and OFF the premises

NAME, (REGISTERED) ADDRESS OF HOLDER OF PREMISES LICENCE

Parmjit Kaur

16 Bank Street, West Bromwich, West Midlands, B71 1HF.

REGISTERED NUMBER OF HOLDER, FOR EXAMPLE COMPANY NUMBER, CHARITY NUMBER (WHERE APPLICABLE)



Licensing Act 2003

PL0610

Premises Licence Summary

NAME OF DESIGNATED PREMISES SUPERVISOR WHERE THE PREMISES LICENCE AUTHORISES THE SUPPLY OF ALCOHOL

Mathew SHAW

STATE WHETHER ACCESS TO THE PREMISES BY CHILDREN IS RESTRICTED OR PROHIBITED

Not applicable



Locomotive Sports Bar

Cheeky bar & smoking un outside area with pathway access

Address: Cheeky Bar, 28 Station Street, Burton-Upon-Trent, DE14 3AU

Date: 9th May 2017

Scale: 0.5cm = 1m

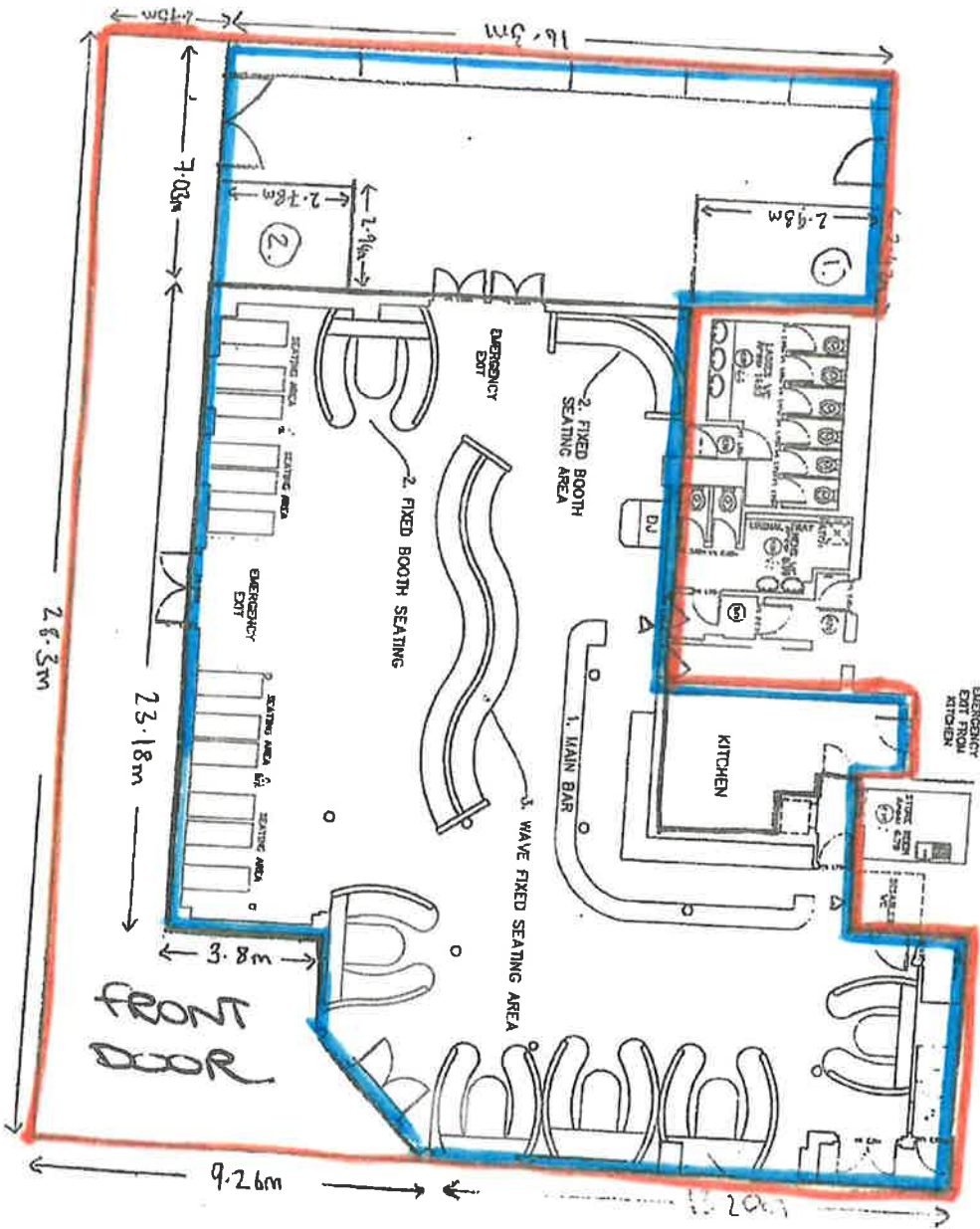
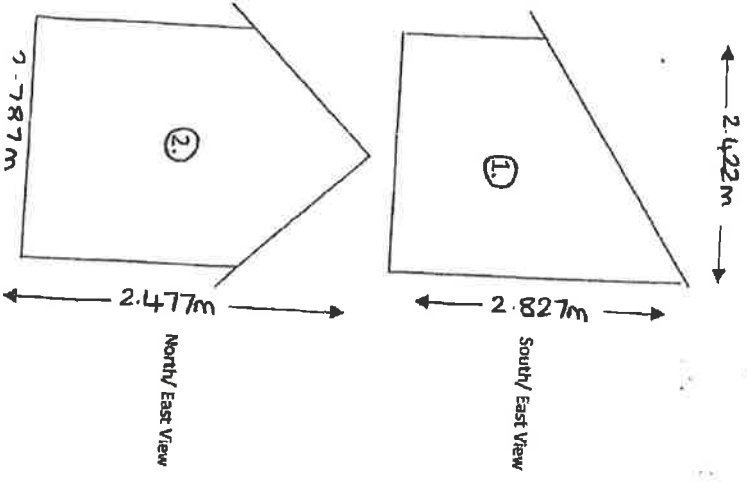

Refs: 08102019 / 610

~~Ref: 08102019 / 610~~

ALCOHOL BY RETAIL
REGULATED CUSTOMERS

LATE NIGHT REFRESHMENT